

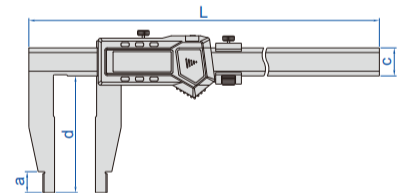
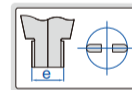

**1106-501**

- Non waterproof
- Resolution: 0.01mm/0.0005"
- Button function: on/off, zero, mm/inch, ABS, data preset
- Battery CR2032
- Made of stainless steel
- Optional accessory:  
accessory set for large digital calipers  
(code **6145-500/6146-500B**, for calipers with c=24mm)

**With data interface**
**(mm)**

Code	Range	Accuracy	a	c	d	e	L	Data output cable (optional)
1106-301	0-300mm/0-12"	±0.05mm	18	24	100	20	420	7315-22 need receiver page 4, 7302-22 page 12
1106-302	0-300mm/0-12"	±0.05mm	18	24	150	20	475	7315-22 need receiver page 4, 7302-22 page 12
1106-451	0-450mm/0-18"	±0.05mm	18	24	100	20	625	7315-22 need receiver page 4, 7302-22 page 12
1106-501	0-500mm/0-20"	±0.05mm	18	24	100	20	675	7315-22 need receiver page 4, 7302-22 page 12
1106-502	0-500mm/0-20"	±0.06mm	18	24	150	20	675	7315-22 need receiver page 4, 7302-22 page 12
1106-503	0-500mm/0-20"	±0.06mm	24	31	200	20	675	7315-22 need receiver page 4, 7302-22 page 12
1106-505	0-500mm/0-20"	±0.08mm	24	42	300	20	675	7315-20B need receiver, 7302-SPC1A
1106-601	0-600mm/0-24"	±0.05mm	18	24	100	20	770	7315-22 need receiver page 4, 7302-22 page 12
1106-602	0-600mm/0-24"	±0.06mm	18	24	150	20	770	7315-22 need receiver page 4, 7302-22 page 12
1106-603	0-600mm/0-24"	±0.06mm	24	31	200	20	825	7315-22 need receiver page 4, 7302-22 page 12
1106-802	0-800mm/0-32"	±0.07mm	24	31	150	20	1025	7315-22 need receiver page 4, 7302-22 page 12
1106-1002	0-1000mm/0-40"	±0.08mm	24	31	150	20	1220	7315-22 need receiver page 4, 7302-22 page 12
1106-1003	0-1000mm/0-40"	±0.08mm	24	31	200	20	1220	7315-22 need receiver page 4, 7302-22 page 12
1106-1005	0-1000mm/0-40"	±0.10mm	24	42	300	20	1220	7315-20B need receiver, 7302-SPC1A
1106-1502	0-1500mm/0-60"	±0.11mm	24	42	150	20	1780	7315-20B need receiver, 7302-SPC1A
1106-1503	0-1500mm/0-60"	±0.12mm	24	42	200	20	1780	7315-20B need receiver, 7302-SPC1A
1106-2002	0-2000mm/0-80"	±0.14mm	24	42	150	20	2290	7315-20B need receiver, 7302-SPC1A
1106-2003	0-2000mm/0-80"	±0.14mm	24	42	200	20	2290	7315-20B need receiver, 7302-SPC1A
1106-2502	0-2500mm/0-100"	±0.22mm	24	42	150	20	2800	7315-20B need receiver, 7302-SPC1A
1106-3002	0-3000mm/0-120"	±0.26mm	24	42	150	20	3300	7315-20B need receiver, 7302-SPC1A

**Built-in wireless (receiver code 7315-2/3/6/7/8/9 is required)**

Code	Range	Accuracy	a	c	d	e	L
1106-301WL	0-300mm/0-12"	±0.05mm	18mm	24mm	100mm	20mm	420mm
1106-302WL	0-300mm/0-12"	±0.05mm	18mm	24mm	150mm	20mm	420mm
1106-451WL	0-450mm/0-18"	±0.05mm	18mm	24mm	100mm	20mm	625mm
1106-501WL	0-500mm/0-20"	±0.05mm	18mm	24mm	100mm	20mm	675mm
1106-502WL	0-500mm/0-20"	±0.06mm	18mm	24mm	150mm	20mm	675mm
1106-601WL	0-600mm/0-24"	±0.05mm	18mm	24mm	100mm	20mm	770mm
1106-602WL	0-600mm/0-24"	±0.06mm	18mm	24mm	150mm	20mm	770mm